



# Joniec



**ASSEMBLY  
INSTRUCTIONS FOR**

**FENCE SPAN**

[www.joniec.eu](http://www.joniec.eu)

**F.P.U.H. JONIEC®**  
Mieczysław Joniec  
Tymbark 109  
34-650 Tymbark

**t:** +48 18 332 53 90  
**m:** +48 602 539 182  
**e:** [joniec@joniec.pl](mailto:joniec@joniec.pl)

## I. INSTRUCTIONS FOR FOLDING THE COMO / VERO PANEL

1.

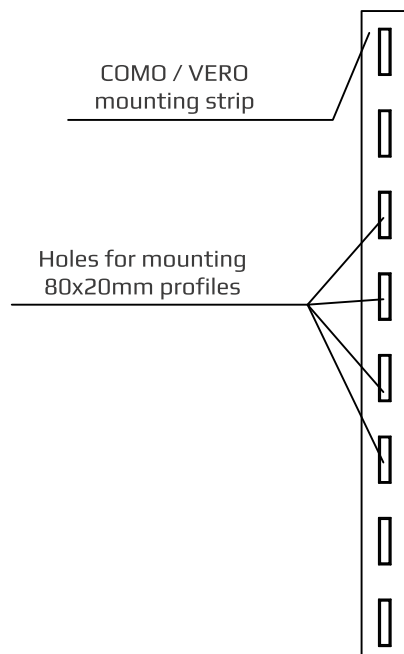

2.

The profile is mounted to the slat by sliding into the prepared holes. Repeat the process until the entire assembly bar is filled with 80x20mm profiles.

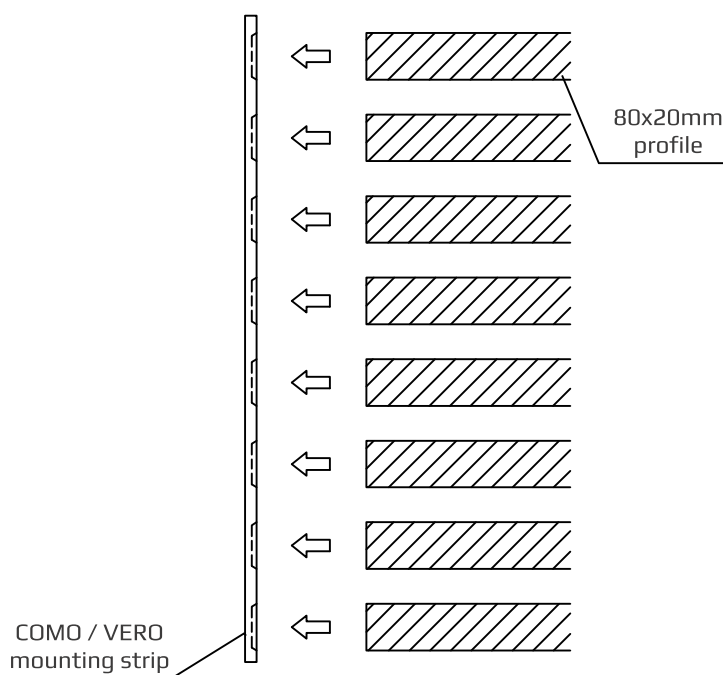

**3.**

After assembling the 80x20 mm profiles with the first strip, we put the second strip and align the 80x20 mm profiles to the holes of the strip then press the strip so that the profiles lock into the prepared hole.

Only such prepared panel can be mounted to poles.

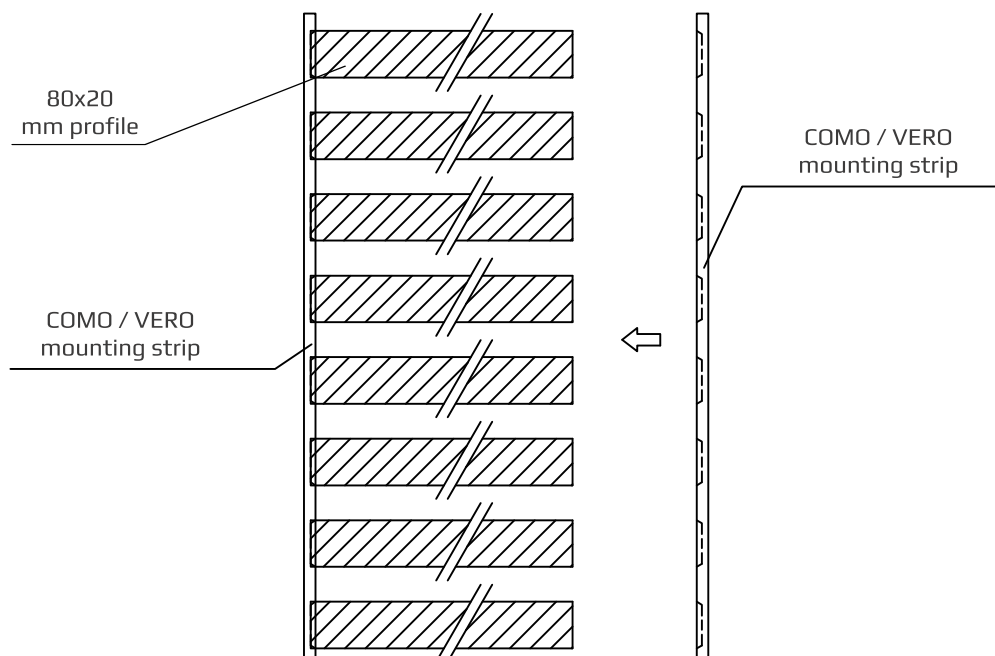
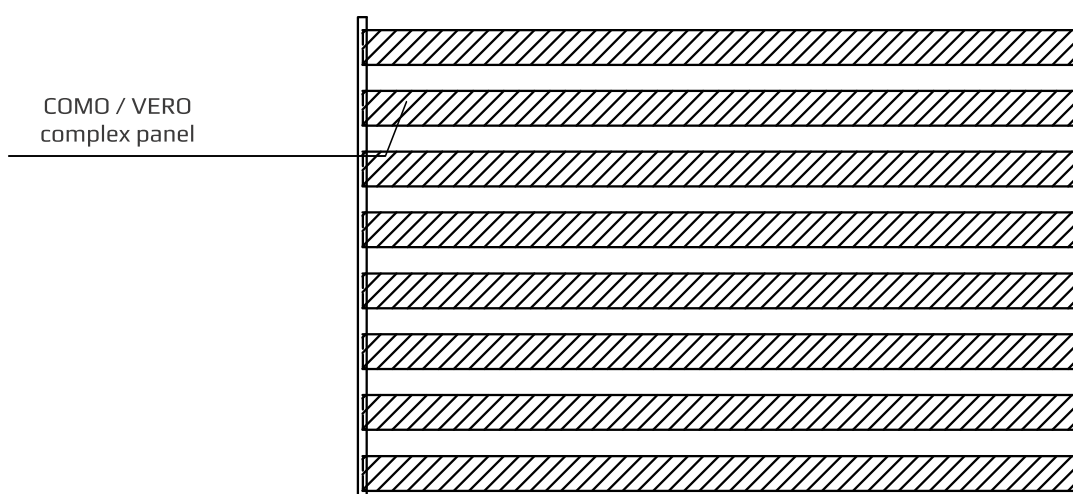

**4.**

## II.INSTALLATION INSTRUCTIONS FOR COMO / VERO PANEL

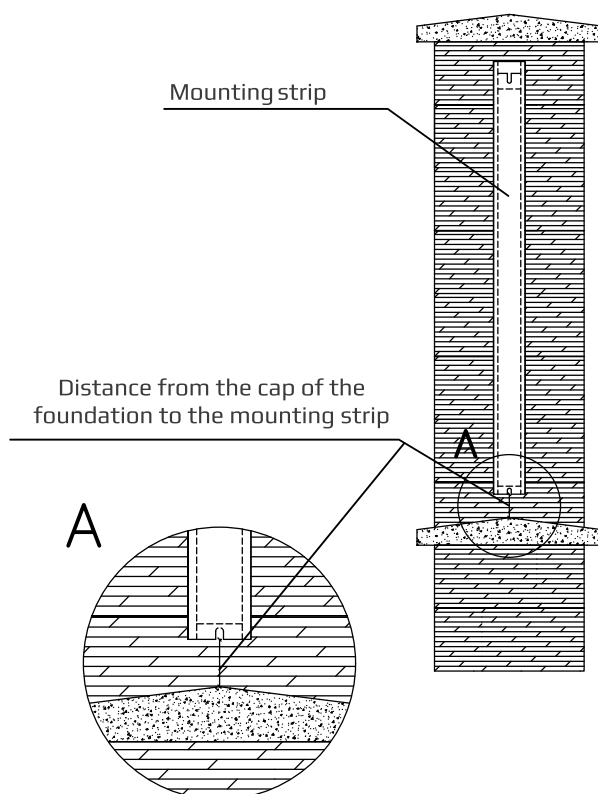
1.

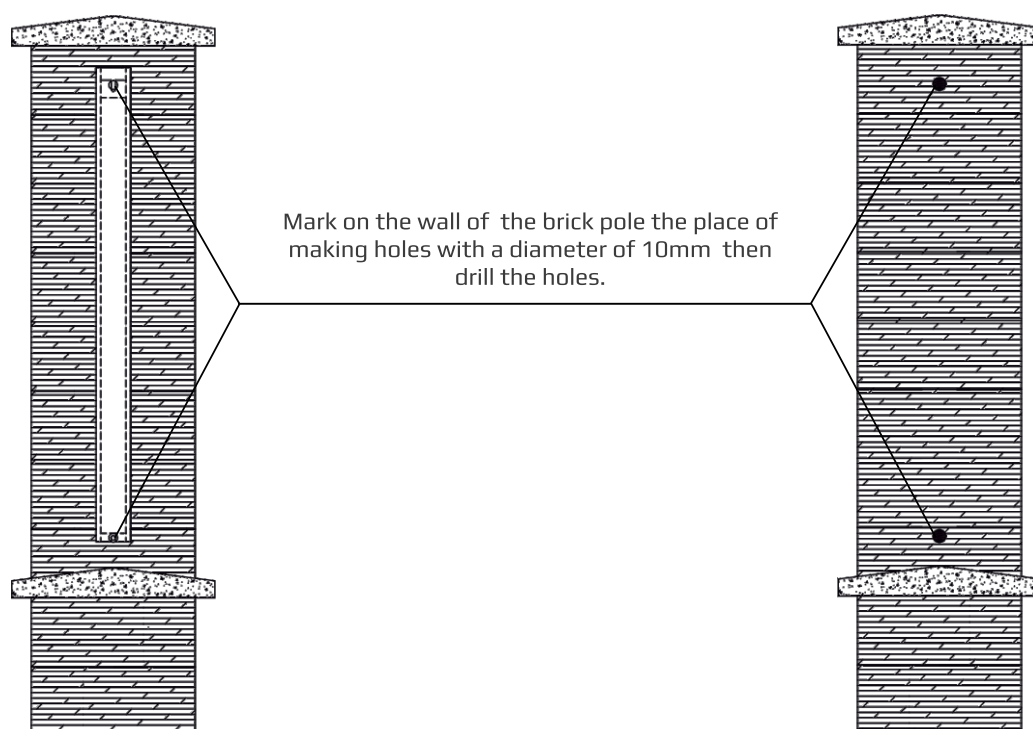

2.





3.

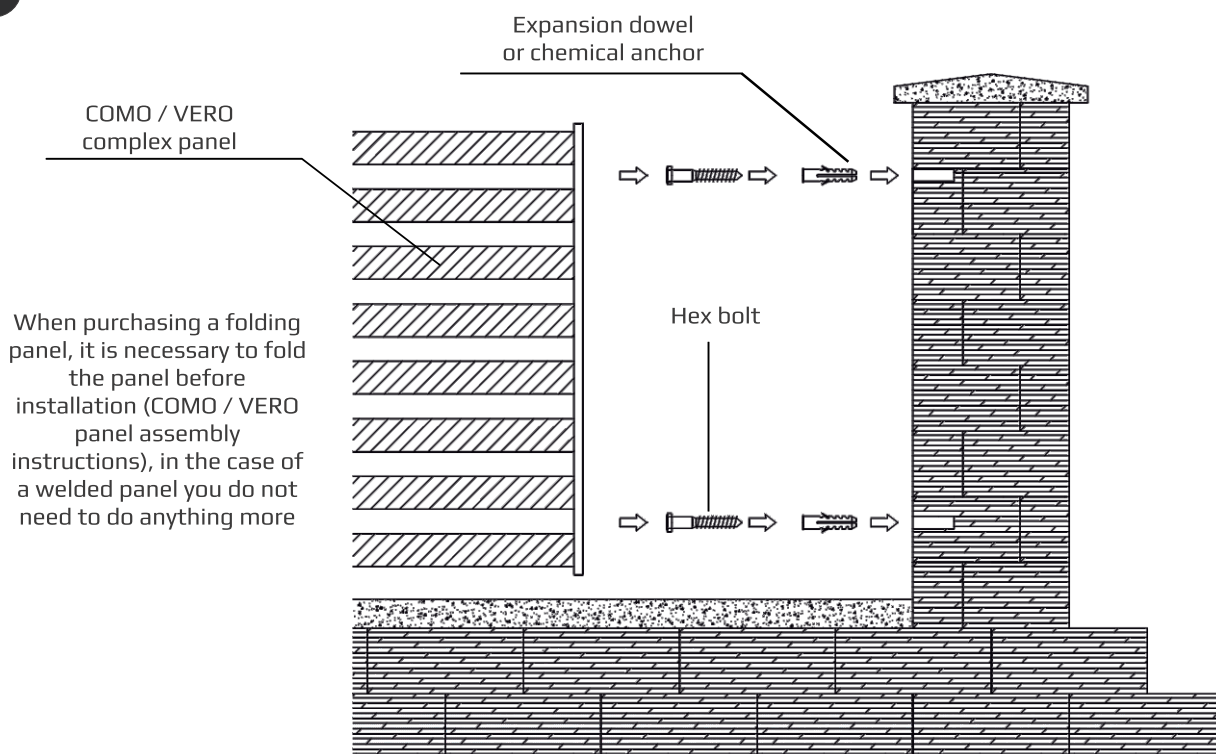

4.

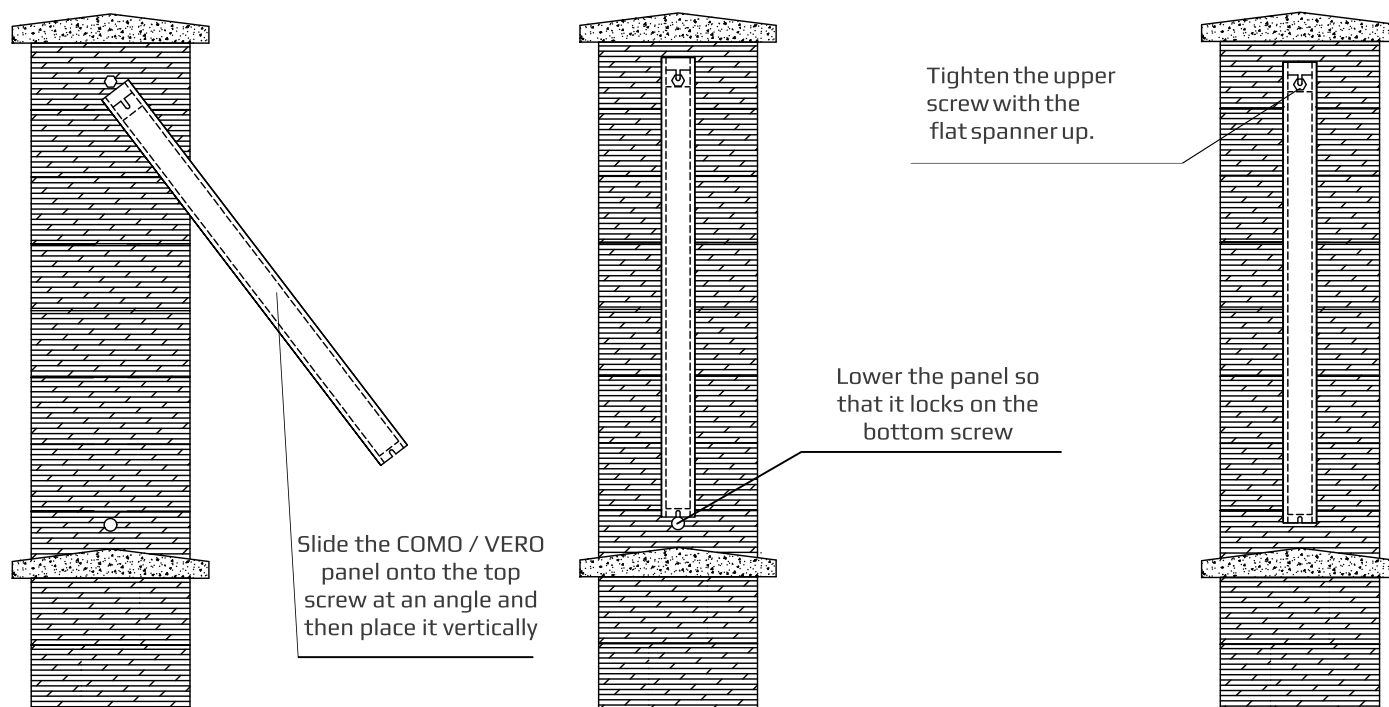

### III. INSTALLATION INSTRUCTIONS FOR THE GABION SEGMENTS

1. The bay consists of two mounting slats for masonry posts with polyamide caps and a gabion panel.
2. Six chemical anchors with a diameter of 9 mm or 6 expansion dowel with a diameter of 10 mm are needed for assembly.
3. Holes should be drilled for mounting strips. To do this, measure the distance from the cap of the foundation to the mounting strip, put the mounting strip to the post, mark out the locations of the holes to drill with a pen or pencil.
4. Then put the mounting strip away and drill a 10 mm diameter hole with a hammer drill.
5. Depending on the type of mounting element, an expansion dowel should be placed in the hole or after cleaning the hole – glue.
6. After placing the expansion dowels or chemical anchors in the bottom two holes, install the mounting strips on both sides, tighten the expansion dowels or anchors.
7. The gabion segments should be inserted from above into mounted mounting strips and then insert the chemical anchor or expansion dowel into the third hole at the top of the panel so that it passes through the panel. This mounting position protects the panel against unauthorized disassembly.
8. After tightening all screws, put 80x20mm polyamide covers on the upper part of the mounting strips.
9. The gabion segments can be filled with any aggregate with a fraction from 10 to 30 mm or a glass pebble according to your own idea.

## IV. OPTIMA PANEL INSTALLATION - WALL MOUNTING

1.

Put the mounting strip to the designed height.

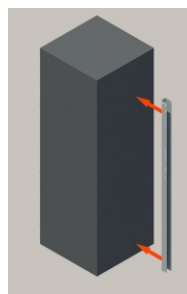

2.

Mark out the locations of the holes to drill

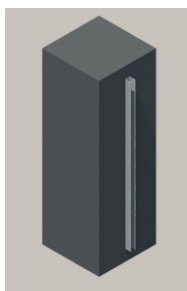

3.

Put the mounting strip in a safe place.

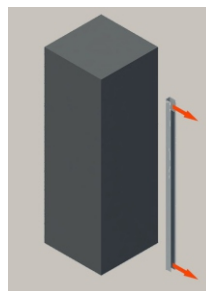

4.

Drill mounting holes.

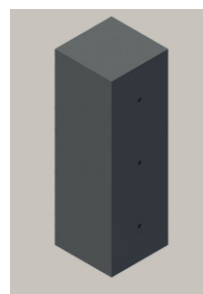

5.

Mount the mounting strip with bolts and expansion dowels.

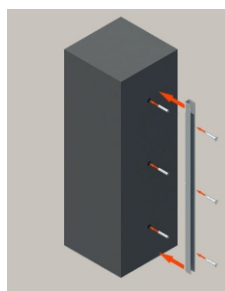

6.

A mounting strip attached to the wall, ready for mounting profiles.

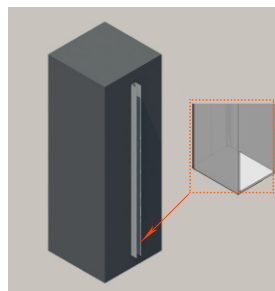

The bend on which the first profile rests

7.

On the lowest profile we put on the cap to which we screw the tape.

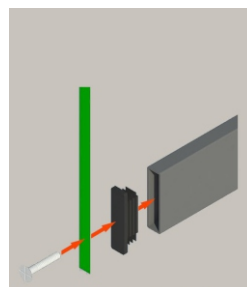

8.

After inserting the first profile, we put a distance on the tape, after which we put the profile on it.

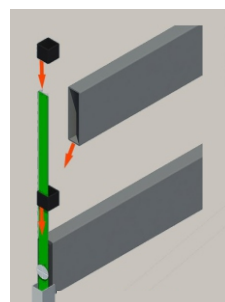

9.

Repeat the action until the last profile.

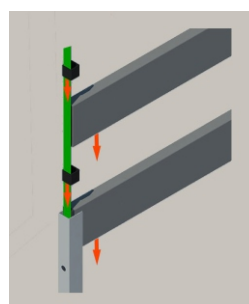

10.

We screw the last profile to the mounting strip to secure the fence.

